



Nominal Diameter

**2,5** = 6,25 mm<sup>2</sup>

TEMA Series

**THP1000**

60% of actual size

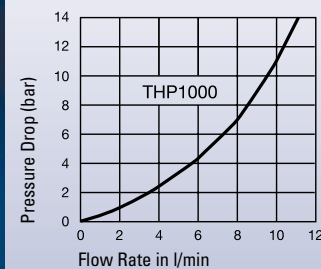
**Flow Capacity Viscosity  
for 37cSt at 40°C  
as per ISO 7241/2-2000**

**Technical Description**

The TEMA high pressure coupling was specially developed for use in industrial machinery, salvage devices and testing equipment. This series is galvanised and produced in steel. The plug part and the sleeve are hardened and galvanised in steel. The coupling can be supplied either with or without additional safety lock.

**Advantages**

High flow as a result of optimised valve design. Additional plug sealing via polymer valve casing, to guarantee high reliability seals even with second-hand plugs. TEMA high pressure couplings are supplied with dust caps inclusive!

**Seals**

Coupling:  
bonded seal washer  
Plug:  
bonded seal or innercone  
(Bonded steel washer s. page 447)

**Interchangeability**  
CEJN 115

**Working Pressure**  
1000 bar

**Working Temperature**  
-30°C up to +100°C (NBR)

**Available Valves**

**Material**
**Coupling**

Coupling Body  
Sleeve  
Valve  
Springs  
Locking Balls  
Seals  
Inner Sleeve

Steel, Zinc Plated, passivated, sealed  
Steel, Hardened, Zinc Plated, passivated, sealed  
Steel, Zinc Plated, Yellow passivated, sealed  
AISI 301  
AISI 420 C  
NBR  
POM

**Plug**

Plug Body  
Valve  
Springs  
Seals  
Valve Holder

Steel, Hardened, Zinc Plated, passivated, sealed  
Steel, Zinc Plated, Yellow passivated, sealed  
AISI 301  
NBR  
Steel, Galvanised

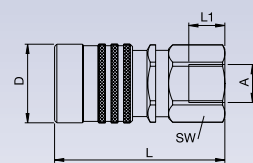
**Couplings**
**TEMA Series THP1000**

**Female Thread**

Connection A	Hex SW	L mm	L1 mm	D mm	Safety Locking	Working press. coupled in bar	Working press. uncoupled in bar	Bursting Press. coup. in bar	Part Number	DS
G 1/4	24	59	12	27	without	1000	1000	>3000	THP10104131	■
G 1/4	24	59	12	27	with	1000	1000	>3000	THP10104132	■
1/4-18 NPTF	24	59	12	27	without	1000	1000	>3000	THP10105131	□
1/4-18 NPTF	24	59	12	27	with	1000	1000	>3000	THP10105132	□
G 3/8	24	59	12	27	without	1000	1000	>3000	THP10104171	■
G 3/8	24	59	12	27	with	1000	1000	>3000	THP10104172	□
3/8-18 NPTF	24	59	13	27	without	1000	1000	>3000	THP10105171	□
3/8-18NPTF	24	59	13	27	with	1000	1000	>3000	THP10105172	□

DS = Delivery Status: ■ in stock

□ on short call

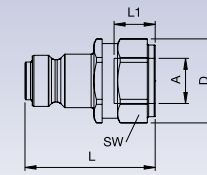
□ medium term delivery

**Plugs**
**TEMA Series THP1000**

**Female Thread**

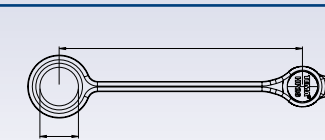
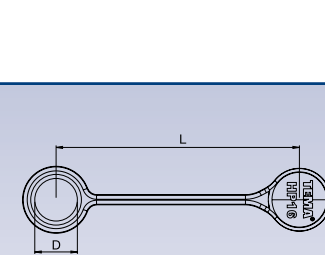
Connection A	Hex SW	L mm	L1 mm	D mm	Working press. coupled in bar	Working press. uncoupled in bar	Bursting Press. coupled in bar	Part Number	DS
G 1/4	22	37	12	24,5	1000	1000	>3000	THP1020413	■
1/4-18 NPTF	22	37	12	24,5	1000	1000	>3000	THP1020513	□
G 3/8	24	37	12	24,5	1000	1000	>3000	THP1020417	■
3/8-18 NPTF	24	37	13	24,5	1000	1000	>3000	THP1020517	□

**Dust Protection**
**TEMA Series THP1000**

Description	L mm	D mm	Colour	Material	Part Number	DS
Coupling	120	21	Blue	PVC	THP16	□
Coupling	125	-	Red	Aluminium	THP16ARD	□
Plug	120	19	Blue	PVC	THP26	□
Plug	140	-	Red	Aluminium	THP26ARD	□

DS = Delivery Status:

■ in stock

□ on short call

□ medium term delivery

DS = Delivery Status: ■ in stock

□ on short call

□ medium term delivery



Nominal Diameter

**2,5** = 6,25 mm<sup>2</sup>

TEMA Series

**THP1500**

auf 60% verkleinert

**Technical Description**

The TEMA high pressure coupling was specially developed for use in bolt tensioning equipment. This series is produced in steel. The coupling body is QPQ-treated. The plug bodies are black galvanised. The coupling can be supplied either with or without additional safety lock.

**Advantages**

High flow as a result of optimised valve design. Additional plug sealing via polymer valve casing, to guarantee high reliability seals even with second-hand plugs. TEMA high pressure couplings are supplied with dust caps inclusive!

**Seals**

Metal sealing cone threaded adapters/metal sealing cone adapters.

**Interchangeability**

CEJN 116

**Working Pressure**

1500 bar

**Working Temperature**

-30°C up to +100°C (NBR)

**Available Valves****Material****Coupling**

Coupling Body  
Sleeve  
Valve  
Springs  
Locking Balls  
Seals  
Inner Sleeve

Steel, Zinc-iron coated, black passivated, sealed  
Steel, Hardened, Zinc-iron coated, black passivated, sealed  
Steel, Zinc Plated, Yellow passivated, sealed  
AISI 301  
AISI 420 C  
NBR  
POM

**Plug**

Plug Body  
Valve  
Springs  
Seals  
Valve Holder

Steel, Hardened, Zinc-iron coated, black passivated, sealed  
Steel, Zinc Plated, Yellow passivated, sealed  
AISI 301  
NBR  
Steel, Galvanised

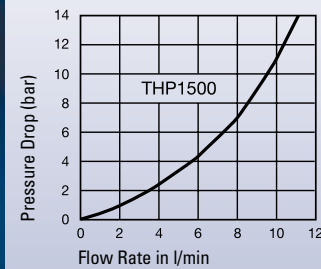
**Flow Capacity Viscosity  
for 37cSt at 40°C  
as per ISO 7241/2-2000**
**Couplings****TEMA Series THP1500**

Connection A	Hex SW	L mm	L1 mm	D mm	Safety Locking	Working press. coupled in bar	Working press. uncoupled in bar	Bursting Press. coup. in bar	Part Number	DS
G 1/4	24	59	12	27	without	1500	1500	>3500	THP15104131	■
G 1/4	24	59	12	27	with	1500	1500	>3500	THP15104132	■
1/4-18 NPTF	24	59	12	27	without	1500	1500	>3500	THP15105131	■
1/4-18 NPTF	24	59	12	27	with	1500	1500	>3500	THP15105132	■
G 3/8	24	59	12	27	without	1500	1500	>3500	THP15104171	■
G 3/8	24	59	12	27	with	1500	1500	>3500	THP15104172	■
3/8-18 NPTF	24	59	13	27	without	1500	1500	>3500	THP15105171	■
3/8-18 NPTF	24	59	13	27	with	1500	1500	>3500	THP15105172	■

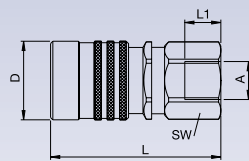

Female Thread

DS = Delivery Status: ■ in stock

■ on short call

■ medium term delivery

**Plugs****TEMA Series THP1500**

Connection A	Hex SW	L mm	L1 mm	D mm	Working press. coupled in bar	Working press. uncoupled in bar	Bursting Press. coupled in bar	Part Number	DS
G 1/4	22	38	12	24,5	1500	1500	>3500	THP1520413	■
1/4-18 NPTF	22	38	12	24,5	1500	1500	>3500	THP1520513	■

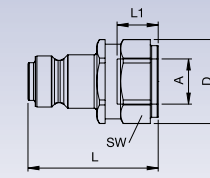

Female Thread

**Dust Protection****TEMA Series THP1500**

Description	L mm	D mm	Color	Material	Part Number	DS
Coupling	120	21	Blue	PVC	THP16	■
Coupling	125	-	Red	Aluminium	THP16ARD	■
Plug	120	19	Blue	PVC	THP26	■
Plug	140	-	Red	Aluminium	THP26ARD	■

DS = Delivery Status:

■ in stock

■ on short call

■ medium term delivery

## Adapter HP-Series

## TEMA Adapter

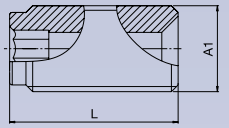
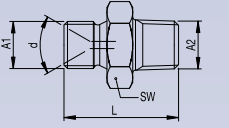
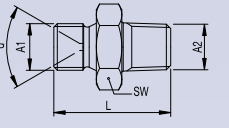
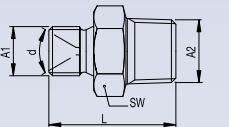
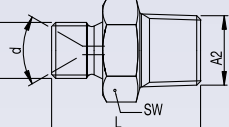
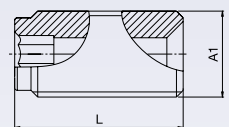
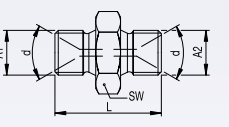
	Working Press. in bar	Connection A1	Seal 1	Connection A2	Seal 2	L mm	Hex SW	Part Number	DS
	1000	G 1/4 o.	Rubber/Steel			25		THP13-01	■
	1000	G 1/4 o.	Rubber/Steel	1/4-18 NPTF	inside Thread	32	21	THP13-02	■
	1000	G 1/4 o.	Rubber/Steel	R 1/4 AG	inside Thread	33	21	THP13-03	■
	1500	G 1/4 o.	Rubber/Steel	3/8-18 NPTF	inside Thread	34	21	THP13-04	■
	1000	G 1/4 o.	Rubber/Steel	R 3/8 AG	inside Thread	35	21	THP13-05	■
	1500	G 1/4 o.	Rubber/Steel			25		THP13-06	■
	2000	G 1/4 o.	Inner Cone 60°	G 1/4 AG	Inner Cone 60°	31,3	21	THP13-07	■

DS = Delivery Status: ■ in stock

■ on short call

□ medium term delivery

## Adapter HP-Series

## TEMA Adapter

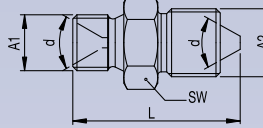
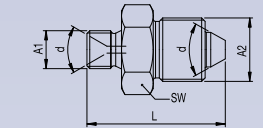
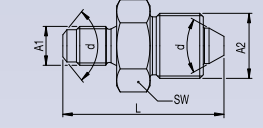
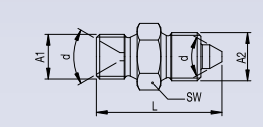
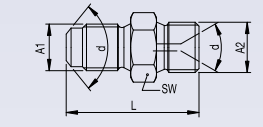
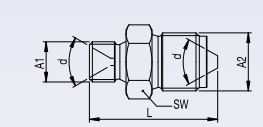
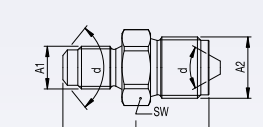
	Working Press. in bar	Connection A1	Seal 1	Connection A2	Seal 2	L mm	Hex SW	Part Number	DS
	2000	G 1/4 o.	Inner Cone 60°	M 16 x 1,5 AG	Outside Cone 60°	39,4	19	THP13-08	■
	2000	G 1/4 o.	Inner Cone 60°	M 22 x 1,5 AG	Outside Cone 60°	48	27	THP13-09	■
	2000	G 1/4 o.	Outside Cone 120°	M 22 x 1,5 AG	Outside Cone 60°	54,5	27	THP13-10	■
	2000	G 1/4 o.	Inner Cone 60°	9/16-18 UNF	Outside Cone 60°	37	17	THP13-11	■
	2000	G 1/4 o.	Outside Cone 120°	9/16-18 UNF	Inner Cone 60°	37,5	17	THP13-12	■
	2000	G 1/4 o.	Inner Cone 60°	3/4-16 UNF	Outside Cone 60°	42	21	THP13-13	■
	2000	G 1/4 o.	Outside Cone 120°	3/4-16 UNF	Outside Cone 60°	48,5	21	THP13-14	■

DS = Delivery Status: ■ in stock

■ on short call

□ medium term delivery

Further adapters and manifolds on request.