

Type **TW59**

WEH[®] Connector for filling of gas cylinders

with propane and butane



General

DESCRIPTION



Features

- Suitable for filling of propane and butane
- Connection in seconds
- No hand tightening required
- Integrated shut-off valve
- WEH® Jaw locking mechanism
- Single-handed operation
- Robust construction
- High-grade materials

The type TW59 quick connector is specifically designed for the filling of gas cylinders with propane and butane and represents a major step in the technology of safe application, economy, ergonomics and flexibility.

Type TW59 provides an intrinsically safe connection. The seal between the quick connector and the gas cylinder valve is mechanically actuated and the sealing force is increased by the gas filling pressure. This means that there is no need for a compressed air safety reservoir, the air supply is used to withdraw the seal when connecting / disconnecting in order to achieve effortless operation.

If needed, a second pneumatic inlet is provided for pilot pressure. This can be used to indicate the operational condition of the connector – i.e. whether connected or disconnected - and could for example be used to automatically begin the loading and unloading of the gas cylinders from the filling station.

No additional valves required

The integrated shut-off valve prevents the leakage of gas when connecting and disconnecting. The gas flow is immediately interrupted when disengaging the pressurized connector.

Safety tested

The type TW59 is TÜV tested and meets the requirements of the technical regulations for gases (TRG).

Application

Quick connector for filling of gas cylinders with propane and butane on connection acc. to DIN 477 part 1 Nr. 1 and 2

TECHNICAL DATA

Characteristic	Basic version
Pressure range	PN = 24 bar PS = 30 bar PT = 45 bar
Pilot pressure	6 - 8 bar
Pilot pressure port P1	M5
Pilot pressure port P2	M5 - if this feature is not required the port must be fitted with a blanking plug (factory fitted)
Temperature range	+5 °C up to +95 °C
Connection A	Connection acc. to DIN 477 part 1 no. 1 and 2
Medium	Propane, butane
Actuation	Manual actuation via sliding sleeve (pneumatically supported)
Material	Corrosion resistant stainless steel, aluminium
Sealing material	Acc. to gas type
Registration	TÜV test available

Other designs on request

Example of use:



Ordering / Accessories

ORDERING | Quick connector TW59

approx. dimensions (mm)

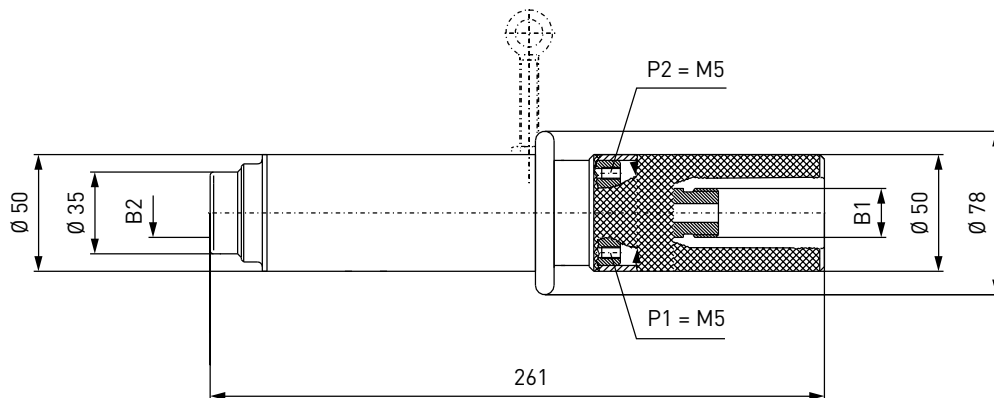

Part No.	Description	Inlet B1 (external thread)	Connection B2 (external thread)
C1-10291	TW59	W21.8x1/14" left	W21.8x1/14" left

Other connection sizes and versions on request.

ACCESSORIES

The following accessories are available for type TW59:

Spare parts

Various parts are available as spares for type TW59:

Part No.	Description
E51-101N	Special seal

Other products

OTHER PRODUCTS

You will find more products in our current catalogue No. 20



Further information on our homepage
www.weh.com

» Contacting

For queries and further information, please do not hesitate to contact us.

Manufacturer:

WEH GmbH Precision Connectors

Josef-Henle-Str. 1
89257 Illertissen / Germany

Phone: +49 7303 9609-0
Fax: +49 7303 9609-9999

eMail: sales@weh.com
www.weh.com