

SI 25 | DIAPHRAGM PRESSURE REGULATOR / HIGH FLOW

KEY FEATURES

- Gas specific solutions
- Assembling, testing & Packaging in cleanroom:
Class ISO 4
- Controlled (PC) electropolishing for better corrosion resistance
- No spring in the wetted area for zero particle emission
- Multi-port options available



DIMENSIONS

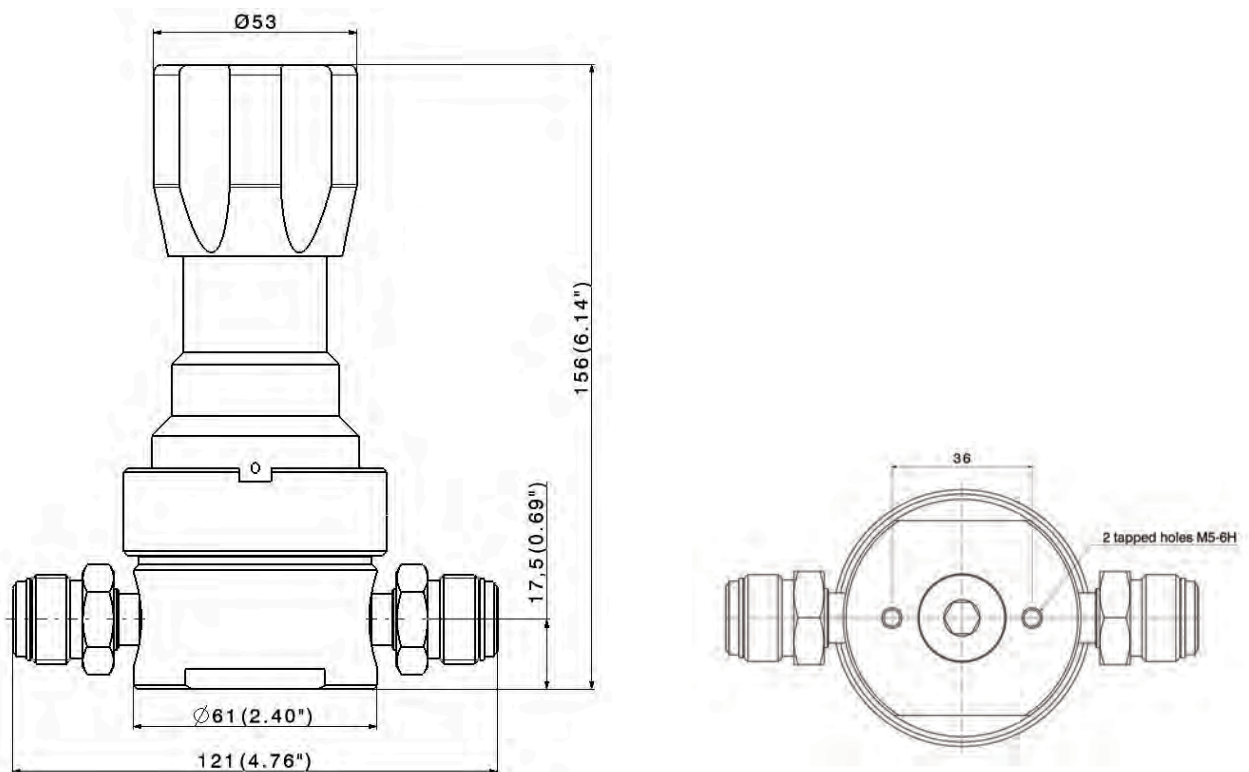

SPECIFICATIONS

Fluid media	Standard, high or ultra high purity corrosive and noncorrosive gases	Temperature range	-20°C to +60°C (-4°F to +140°F)	Number of ports	2, 3 or 4
Max. inlet pressure	50 bar (363 psig)	Flow capacity (Cv)	1.2	Certified max. Helium outboard leak rate	$\leq 1 \times 10^{-9}$ mbar.l/s
Outlet pressure	5/10 bar (73/145 psig)	Burst pressure*	300% of operating pressure	Supply pressure effect I*	6 bar / 100 bar
		Proof pressure*	150% of operating pressure		

* According to CGA-E4

CONSTRUCTION MATERIAL

	Parts	Material
Wetted parts	Body	SS 316L, VAR
	Seat	PFA, PCTFE
	Diaphragm	Hastelloy®
	Poppet	SS 316L
Non-wetted parts	Bonnet	Chrome Plated Brass
	Handwheel	Aluminium
	Others	Stainless Steel and Others

SURFACE FINISH

S	V	U
Ra 0.4 µm (15 µin)	Ra 0.25 µm EP (10 µin)	Ra 0.15 µm EP (6 µin)

RATED FLOW CAPACITY (Q_R*) /
OUTLET PRESSURE (P2)

P2 (bar)	Q _R *(SLPM)
5	730
10	1640

* According to CGA-E4

FLOW CURVES

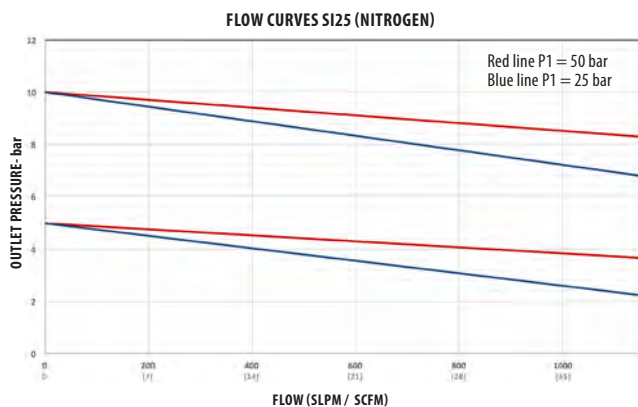

PRODUCT CONFIGURATOR

SI	25	Surface Finish	Porting Configuration	Body Material	Seat Material	Outlet Regulated Pressure	End Connection	Options
		S	2V1	I	K	10b	A/B: V½ F	PG
		Ra 0.4 µm (15 µin Ra)	See page 37	SS 316L	PCTFE (Kel-F®)	5 bar (73 psig)	5b Metal face seal ½" - Female	V½ F Pressure gauge 2"*
		Ra 0.25 µm EP (10 µin)		*On demand	PFA	10 bar (145 psig)	10b Metal face seal ½" - Male	V½ M *Please refer to page 37
		Ra 0.13 µm EP (5 µin)*						

*On demand



Special configuration on demand